

EUROROLL®-BRAKE ROLLERS BRAKE CONVEYOR ROLLERS

Areas of Application

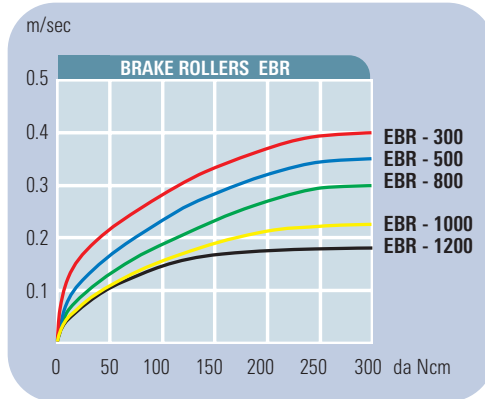
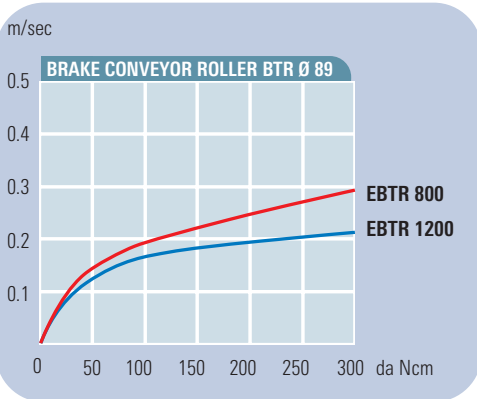
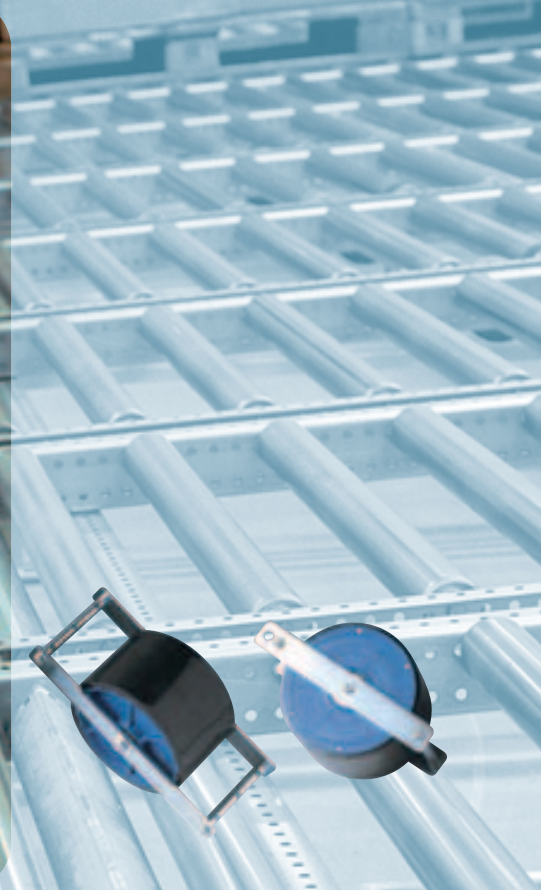
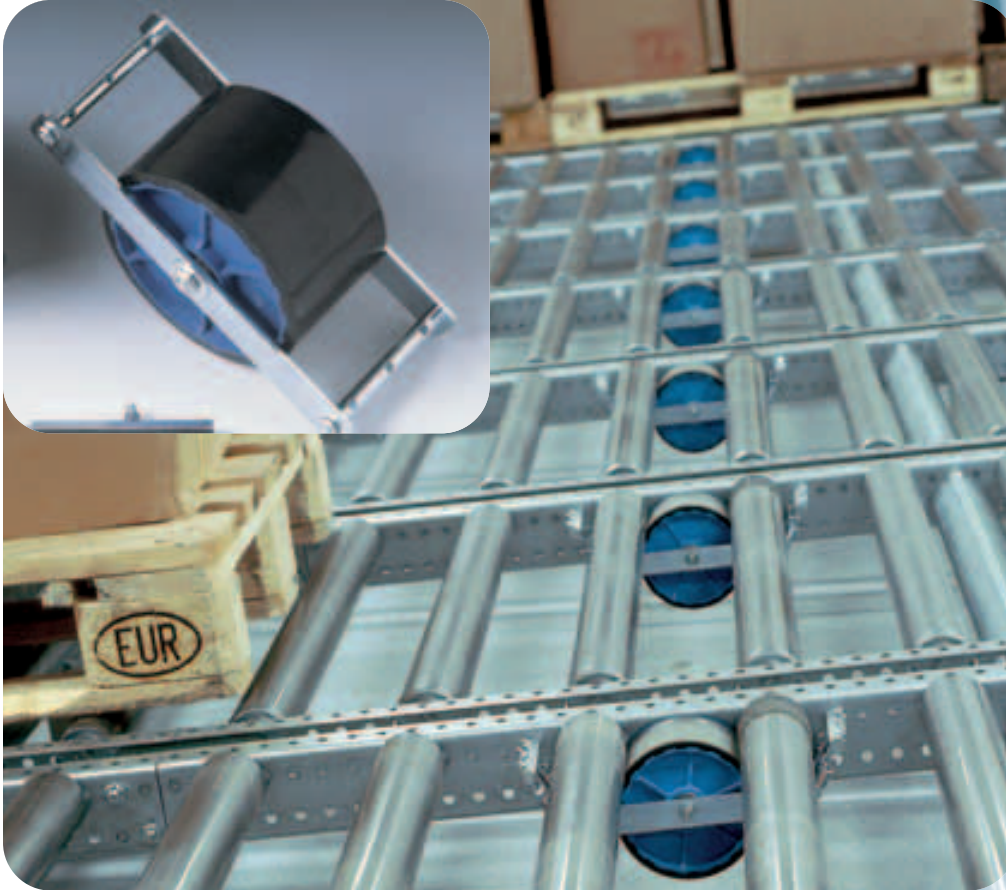

Dependent on the kind of installation EURO-ROLL-Brake Rollers can be supplied with short or long mountings. An extensive range of accessories to install the Brake Rollers and to adjust them exactly supplements the product range.

2 kinds of installation are possible:
Direct or indirect speed control of the pallet to be conveyed.

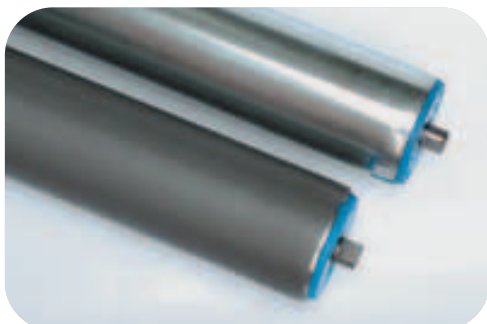

Rubberised Brake Conveyor Roller

EUROROLL supplies Brake Conveyor Rollers where the entire length of the roller has a shrunk-on rubber cover, which is used for steel pallets or plastic pallets. The result is to get a better friction between the Brake Conveyor Roller and the pallet.

BRAKE ROLLERS BRAKE CONVEYOR ROLLERS

EUROROLL-Brake Rollers and EUROROLL-Brake Conveyor Rollers control the speed of the good to be conveyed on roller tracks while they keep the conveyed good at a constant run-off speed. This is achieved by means of planetary gearing, which at each revolution presses the centrifugal brake discs against the roller body, raising it with proportional brake force up to the brake momentum. The distance of the Brake Rollers and the correct brake roller type are influenced by several factors:

1. Construction and capacity of the roller track
2. Declination of the roller track
3. Characteristics of the good to be conveyed (size, weight, sensitivity, barrel-shaped)
4. Resistance of the Brake Roller
5. Environmental conditions, e.g. wet, cold or warm conditions

At least one Brake Roller or Brake Conveyor Roller has to be fitted per pallet place, as only then a controlled speed without acceleration and the appearance of great force can be achieved. The run-off speed should never be above 0.3 m/sec. The run-off speed is only 0.1 – 0.2 m/sec. when the Brake Rollers are correctly positioned. Important is the correct adjustment of the suspension of the Brake Rollers and Brake Conveyor Rollers. As only by means of the necessary pressing between the Brake Roller and the good to be conveyed (conveyor roller or pallet) a contact free from slipping occurs and a constant conveying speed is achieved.

Braking Force Diagram

Braking force diagrams are a great help to choose the correct type of Brake Rollers and Brake Conveyor Rollers. Forces (which mainly arise due to acceleration), which exceed the characteristic curve, can overload and destroy the Brake Rollers. Therefore the Brake Rollers and Brake Conveyor Rollers always have to be fitted in pallet distance in roller tracks or even closer to each other. This means that the pallet in each position is always in contact with a Brake Roller (it's a speed controller).



The EUROROLL-Brake Conveyor Rollers are supplied in two different diameters and laid out for different loads:

Brake Conveyor Roller dia. 80 mm
Brake Conveyor Roller dia. 89 mm

Each Brake Conveyor Roller is delivered together with a set of suspension and therefore can only be installed in a way, that the Brake Conveyor Roller is suspended at maximum level of the roller track or less. The correct level of the moving of the elastic

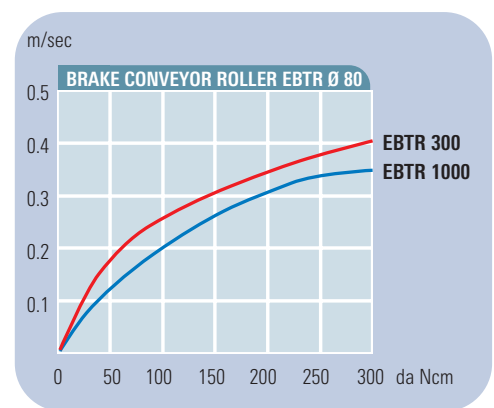

suspension and the lowest level of the top of the Brake Conveyor Roller have to be determined by carrying out careful measurements. (Figure based on experience: approx. 1 – 2 mm above roller upper level).

It is very important, that each Brake Conveyor Roller is exactly adjusted and checked. When using fixed holders the Brake Conveyor Roller will always be adjusted above the upper level of the rollers of the roller track. The level has also got to be determined by carrying out careful tests and then will be exactly adjusted.

TYPES OF INSTALLATIONS

Fixed installation, with flat spring suspension:
EBTB

Brake Conveyor Roller dia. 80 mm with flat spring suspension:
Load up to 300 kg: **EBTB 300**

Brake Conveyor Roller dia. 80 mm with flat spring suspension:
Load up to 1000 kg: **EBTB 1000**

The installation length **EL** (in mm)

Design of the bracing tube:
Tube bright steel - **B**
Tube zinc-plated: - **I**

Deep-freeze version: - **TK**

Rubberised coating for steel
and plastic pallets: - **G**

Order example: EBTB 300 – 872 – I – G

Brake Conveyor Roller with flat spring suspension for pallet weight up to 300 daN (kg), for installation length 872 mm, bracing tube zinc-plated, rubberised.

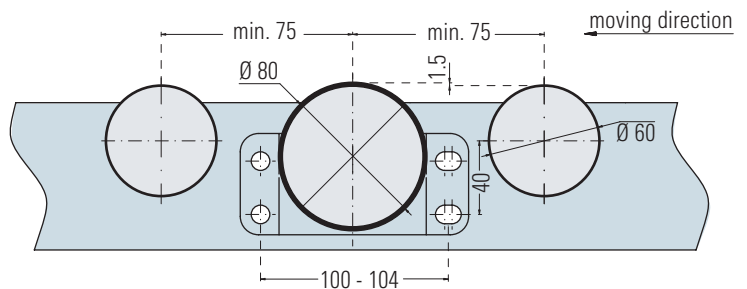
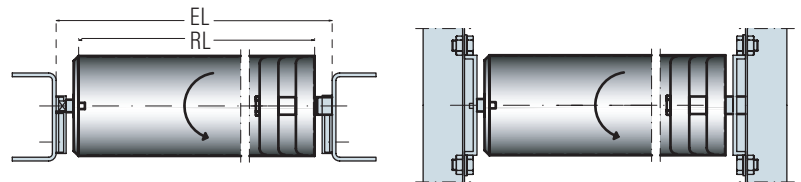
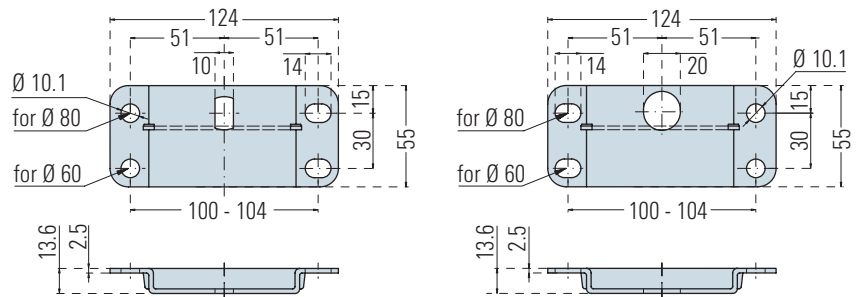

Fixed installation, with stiff suspension: **EBTS**

Brake Conveyor Roller dia. 80 mm with stiff suspension:
Load up to 300 kg: **EBTS 300**

Brake Conveyor Roller dia. 80 mm with stiff suspension:
Load up to 1000 kg: **EBTS 1000**

Installation length **EL** (in mm)

Design of the bracing tube:
Tube bright steel: - **B**
Tube zinc-plated: - **I**

Deep-freeze version: - **TK**

Rubberised coating for steel
and plastic pallets: - **G**

Order example: EBTS 1000 – 872 – B

Brake Conveyor Roller with stiff suspension for pallet weight up to 1000 daN (kg), for installation length 872 mm, bracing tube bright

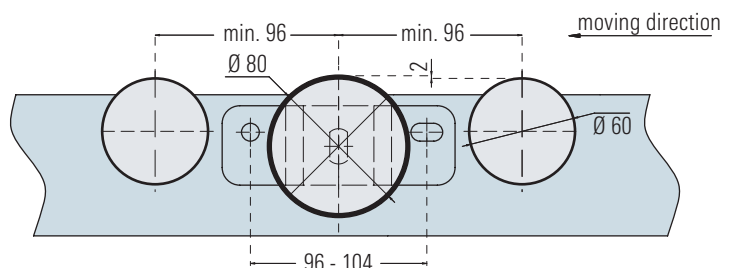
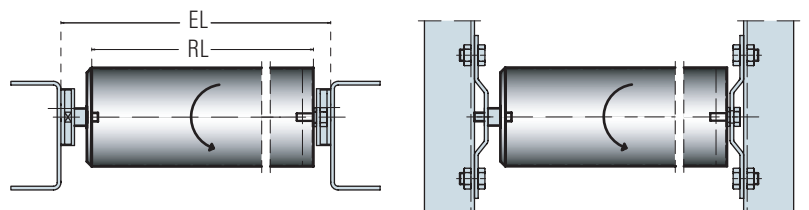
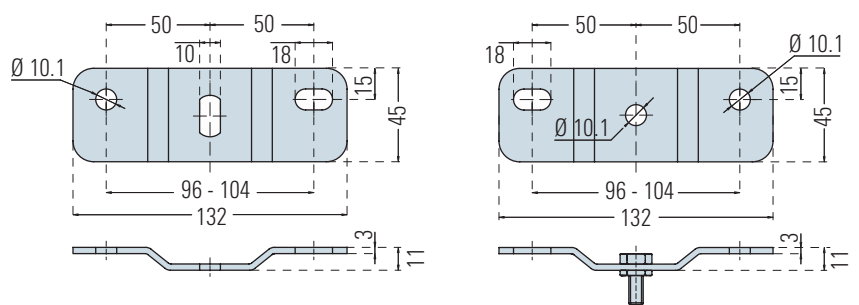

EUROROLL®-BRAKE CONVEYOR ROLLERS dia. 80 mm

Dimensions, Technical Data

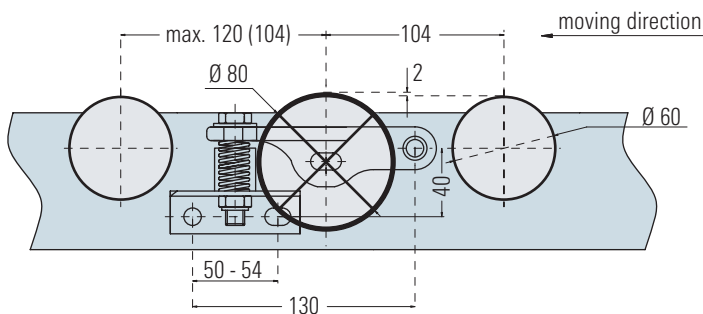
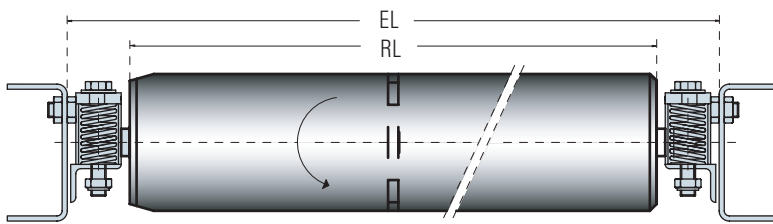
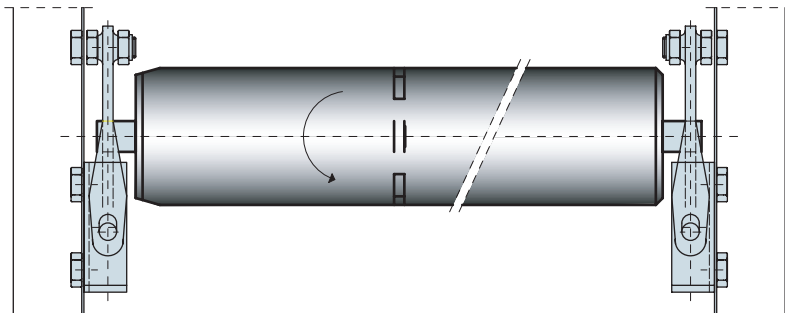
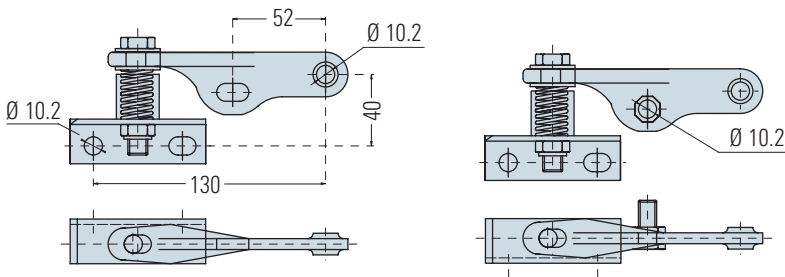

Installation with adjustable, spring suspension:
EBTR

Brake Conveyor Roller dia. 80 mm with adjustable, spring suspension:
Load up to 300 kg: **EBTR 300**

Brake Conveyor Roller dia. 80 mm with adjustable, spring suspension:
Load up to 1000 kg: **EBTR 1000**

Installation length **EL** (in mm)

Design of the bracing tube:

Tube bright steel: - **B**

Tube zinc-plated: - **I**

Deep-freeze version: - **TK**

Rubberised coating for steel and plastic pallet: - **G**

Order example: EBTR 1000-872-I

Brake Conveyor Roller with adjustable spring suspension for pallet weight up to 1000 daN (kg), for fitting length 872 mm, bracing tube zinc-plated.

ACCESSORIES/SPARE PARTS

Brake Conveyor Roller dia. 80 mm, **without** suspension set.

Load up to 300 kg: **EBTR 300-0**

Brake Conveyor Roller dia. 80 mm, **without** suspension set.

Load up to 1000 kg: **EBTR 1000-0**

Order example: EBTR 1000-0-872-I

Brake Conveyor Roller without flat spring suspension set for pallet weight up to 1000 daN (kg), for fitting length 872 mm, bracing tube zinc-plated.

Flat spring suspension (set): **EBTB - BFH**

Fixing suspension (set): **EBTS - STH**

Spring suspension, adjustable: **AHBTR**

BRAKE CONVEYOR ROLLERS dia. 80

LAYOUT

Roller Type	Allowed Pallet Weight	Deliverable Suspension Types	Rollers zinc-plated	Rollers bright	Deep-freeze Version	Contact Coating
EBT - 300	100 - 500 kg	EBTS, EBTB, EBTR	I	B	TK	KB
EBT - 1000	300 - 1000 kg	EBTS, EBTB, EBTR	I	B	TK	KB